

670nm 120mW~130mW Multi-mode Fiber Coupled Diode Laser | Red LD Module
665nm~670nm 120mW Coaxial Pigtailed Laser Diode with MMF | 62.5um, 105um Fiber Optional
RWLP-670-120m-M

670nm Pigtailed Diode Laser		120mW/MM Fiber	
PARAMETER	SYMBOL	VALUE	UNIT
Reverse Voltage	V_r	2.0	V
Operating Temperature	T_{op}	-10~+50	°C
Storage Temperature	T_{stg}	-40~+85	°C
Lead soldering temperature (10 sec.)	T_{is}	260	°C
Features: <ul style="list-style-type: none"> ● 670nm ● MM Fiber ● Coaxial or B82 Package 			
Applications: <ul style="list-style-type: none"> ● Medical Laser Treatment ● Aiming Beam ● Others 			
Specifications	RWLP-670-120m-M		
	Min	Type	Max
Center Wavelength@25°C	670nm±10nm		
Recommended work Temperature	25°C		
Output Power	----	120mW	----
Fiber Type	Multi-mode Fiber		
Fiber Core	105um (50um, 62.5um Optional)		
Monitor Current	----	----	----
PD Reverse Voltage	----	----	----
Fiber Connector	FC/SC/SMA905		
Fiber Length	>80cm		
Threshold Current (Typ.)	----	55mA	85mA
Operating Current (Typ.)	----	220mA	240mA
Operating Voltage	----	2.8V	3.5V
Package Style	Coaxial or B82		

Coaxial Package View: (Part Number: RWLP-670-120m-M)

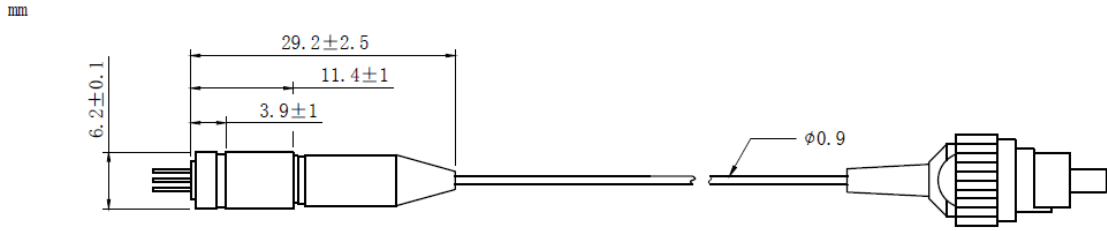

B82 Package View: (Part Number: RWLP-670-120m-M-B)

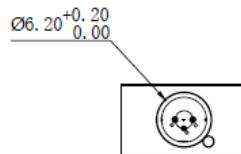
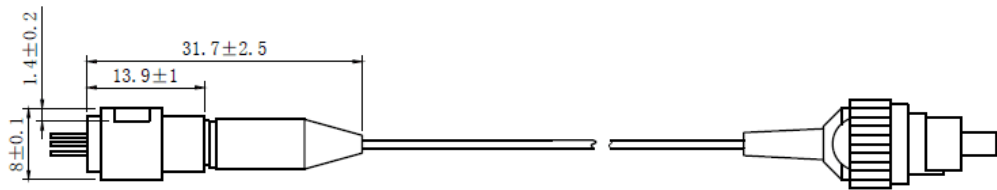
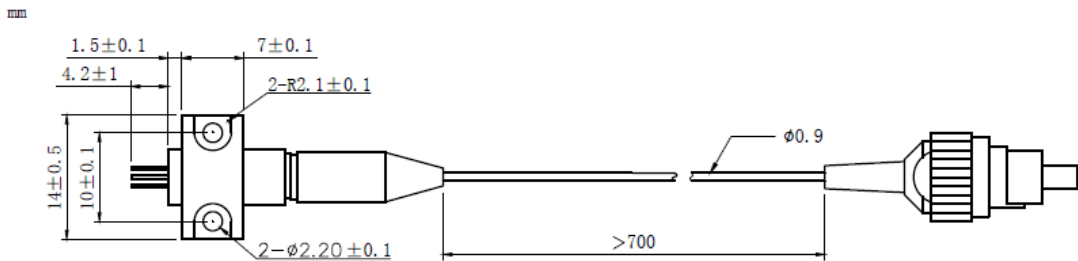

PIN Bottom View:

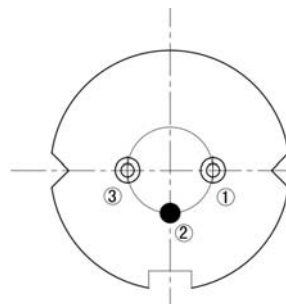

1	LD(+)
2	LD(-)
3	NC

Electrically shorten LD module and store in non-extreme conditions.
Suggest using the constant current power supply.

