

520nm 30mW Coaxial Diode Laser with Polarization Maintaining Fiber| Green Laser Module
515nm~520nm~530nm PM Fiber Coupled Green LD with SMF | Built-in PD Optional
RWLP-520-030m-PM

520nm Pigtailed Diode Laser		30mW/PMF	
PARAMETER	SYMBOL	VALUE	UNIT
Reverse Voltage	V_r	2.0	V
Operating Temperature	T_{op}	-20 ~ +60	°C
Storage Temperature	T_{stg}	-40 ~ +85	°C
Lead soldering temperature (10 sec.)	T_{is}	260	°C
Features: <ul style="list-style-type: none"> 520nm Green Diode Laser PM Fiber High Reliability High Polarization Extinction Ratio 			
Applications: <ul style="list-style-type: none"> Biological Instruments Analytical Equipment Others 			
Specifications	RWLP-520-030m-PM		
	Min	Type	Max
Center Wavelength@25°C	510nm	520nm	530nm
Spectral Width (FWHM)	----	2.0nm	----
Output Power	----	30mW	----
Fiber Type	Polarization Maintaining Fiber		
Fiber Core	3um		
Polarization Extinction Ratio	13dB	15dB	----
Recommend Operating Temperature	25°C		
Fiber Connector	FC/APC		
Fiber Length	>80cm		
Threshold Current	----	65mA	95mA
Operating Current	----	270mA	290mA
Operating Voltage	----	7.0V	8.0V
Photodiode	Optional		
Package Style	Coaxial or B82		
High Polarization Extinction Ratio (PER) Version Laser Module is also available, please contact us.			

Coaxial Package View: (Part Number: RWLP-520-030m-PM)

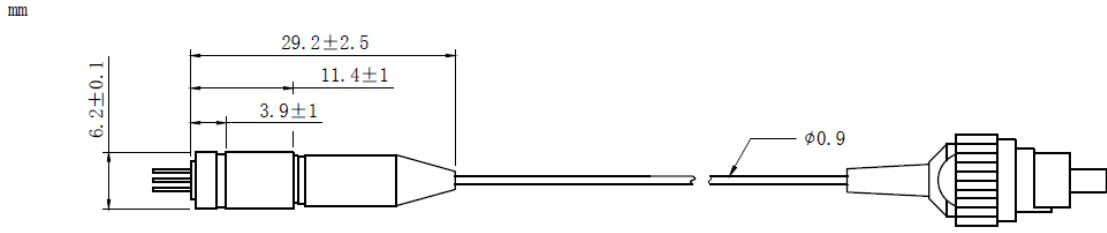

B82 Package View: (Part Number: RWLP-520-030m-PM-B)

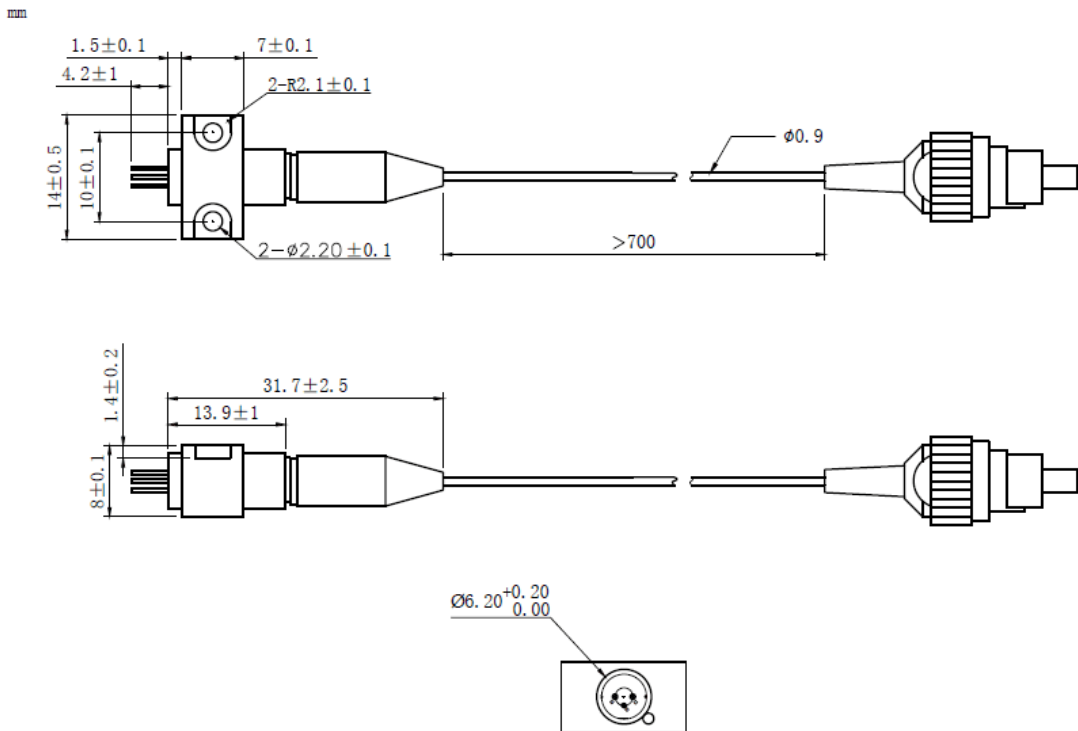

PIN Bottom View:

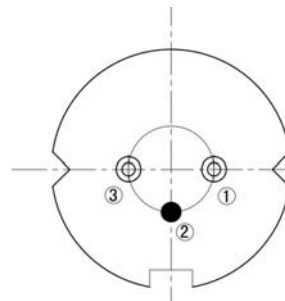

1	LD(+)
2	GND
3	LD(-)

Electrically shorten LD module and store in non-extreme conditions.
Suggest using the constant current power supply.

