

520nm 30mW SM Coaxial Fiber Coupled Laser Diode with SMF | Built-in Photodiode
515nm~520nm~530nm SM Pigtailed Green LD with Single Mode Fiber (SM Fiber) | With PD
RWLP-520-030m-4-PD

520nm Pigtailed Diode Laser		30mW/SMF	
PARAMETER	SYMBOL	VALUE	UNIT
Reverse Voltage	V_r	2.0	V
Operating Temperature	T_{op}	-20 ~ +60	°C
Storage Temperature	T_{stg}	-40 ~ +85	°C
Lead soldering temperature (10 sec.)	T_{is}	260	°C
Features: <ul style="list-style-type: none"> 🔸 520nm Green Diode Laser 🔸 3um SM Fiber 🔸 Coaxial or B82 Package 🔸 Built-in Photodiode 			
Applications: <ul style="list-style-type: none"> 🔸 Medical Laser Treatment 🔸 Others 			
Specifications	RWLP-520-030m-4-PD		
	Min	Type	Max
Center Wavelength@25°C	+/-5nm	520nm	+/-10nm
Spectral Width (FWHM)	----	2.0nm	----
Output Power	----	30mW	----
Fiber Type	Single Mode Fiber		
Fiber Core	3um		
PD Current	100uA		
Recommend Operating Temperature	25°C		
Fiber Connector	FC/SC/SMA905		
Fiber Length	>80cm		
Threshold Current	----	40mA	90mA
Operating Current	----	230mA	250mA
Operating Voltage	----	7.5V	8.0V
Package Style	Coaxial or B82		
Photodiode	Built-in		

Coaxial Package View: (Part Number: RWLP-520-030m-4-PD)

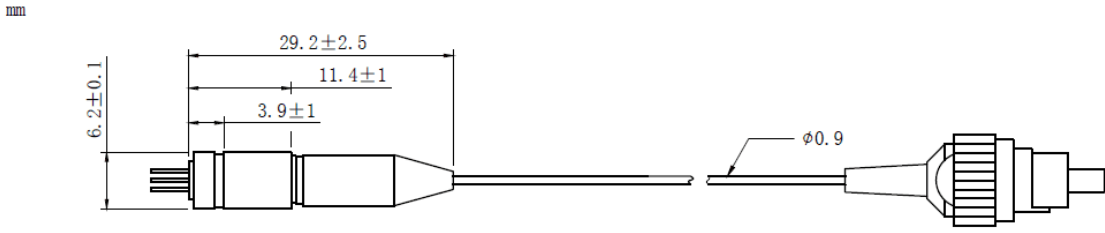

B82 Package View: (Part Number: RWLP-520-030m-4-B-PD)

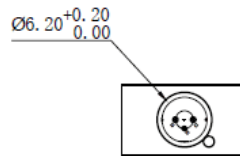
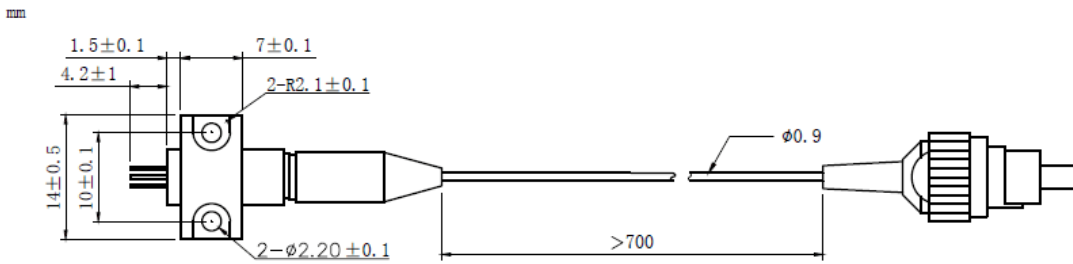

PIN Bottom View:

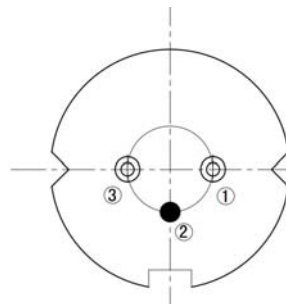

1	LD(-)
2	LD(+)&PD(-)
3	PD(+)

Electrically shorten LD module and store in non-extreme conditions.
Suggest using the constant current power supply.

