

**520nm Green 10mW MM Coaxial Fiber Coupled Laser Diode with MMF| Built-in Photodiode**  
**515nm~520nm~530nm MM Pigtailed LD with 105um 50um 62.5um| With PD**  
**RWLP-520-010m-M-PD**

| 520nm Pigtailed Diode Laser  |  | 10mW/MMF |      |
|--|--|----------|------|
| PARAMETER  | SYMBOL   | VALUE    | UNIT |
| Reverse Voltage  | $V_r$  | 2.0      | V    |
| Operating Temperature  | $T_{op}$   | -10~+60  | °C   |
| Storage Temperature  | $T_{stg}$  | -40~+85  | °C   |
| Lead soldering temperature (10 sec.)   | $T_{is}$   | 260      | °C   |
| <b>Features:</b> <ul style="list-style-type: none"> <li>🔸 520nm Green Diode Laser</li> <li>🔸 With MM Fiber</li> <li>🔸 Coaxial or B82 Package</li> <li>🔸 Built-in Photodiode</li> </ul> |  |          |      |
| <b>Applications:</b> <ul style="list-style-type: none"> <li>🔸 Medical Laser Treatment</li> <li>🔸 Others</li> </ul>   |  |          |      |
| <b>Specifications</b>  | <b>RWLP-520-010m-M-PD</b>  |          |      |
|  | Min  | Type     | Max  |
| Center Wavelength@25°C   | 520nm+/-10nm   |          |      |
| Spectral Width (FWHM)  | ----   | 2.0nm    | ---- |
| Output Power   | ----   | 10mW     | ---- |
| Fiber Type   | Multimode Fiber  |          |      |
| Fiber Core   | 105um (50um, 62.5um Optional)  |          |      |
| PD Current   | 100uA  |          |      |
| Recommend Operating Temperature  | 25°C   |          |      |
| Fiber Connector  | FC/SC/SMA905   |          |      |
| Fiber Length   | >80cm  |          |      |
| Threshold Current (Typ.)   | ----   | 25mA     | 45mA |
| Operating Current (Typ.)   | ----   | 60mA     | 70mA |
| Operating Voltage  | ----   | 6.5V     | 8.0V |
| Package Style  | Coaxial or B82   |          |      |
| Photodiode   | Built-in   |          |      |

**Coaxial Package View: (Part Number: RWLP-520-010m-M-PD)**



**B82 Package View: (Part Number: RWLP-520-010m-M-B-PD)**

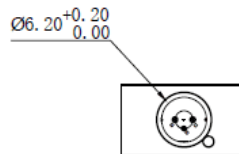
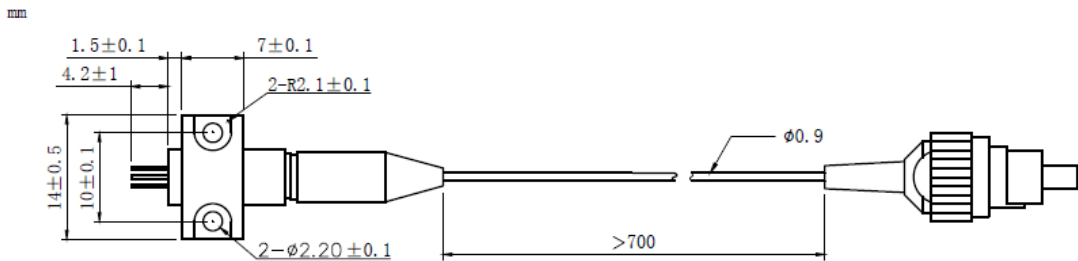

**PIN Bottom View:**

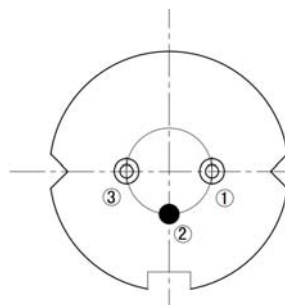

|   |             |
|---|-------------|
| 1 | LD(-)       |
| 2 | LD(+)&PD(-) |
| 3 | PD(+)       |

Electrically shorten LD module and store in non-extreme conditions.  
Suggest using the constant current power supply.

