

505nm 20mW SM Coaxial Diode Laser with Polarization Maintaining Fiber
500nm~505nm~510nm 20mW PM Fiber Coupled Laser Diode with SMF | Green LD Module
RWLP-505-020m-PM

505nm Pigtailed Diode Laser		20mW/PMF	
PARAMETER	SYMBOL	VALUE	UNIT
Reverse Voltage	V_r	2.0	V
Operating Temperature	T_{op}	-10 ~ +60	°C
Storage Temperature	T_{stg}	-40 ~ +85	°C
Lead soldering temperature (10 sec.)	T_{is}	260	°C
Features: <ul style="list-style-type: none"> 505nm Green Diode Laser PM Fiber High Reliability High Polarization Extinction Ratio 			
Applications: <ul style="list-style-type: none"> Biological Instruments Analytical Equipment Others 			
Specifications	RWLP-505-020m-PM		
	Min	Type	Max
Center Wavelength@25°C	±5nm	505nm	±10nm
Spectral Width (FWHM)	----	2.0nm	----
Output Power	----	20mW	----
Fiber Type	Polarization Maintaining Fiber		
Fiber Core	3um		
Polarization Extinction Ratio	13dB	15dB	----
Recommend Operating Temperature	25°C		
Fiber Connector	FC/APC		
Fiber Length	----	80cm	100cm
Threshold Current	----	55mA	95mA
Operating Current	----	220mA	240mA
Operating Voltage	----	7.5V	8.0V
Package Style	Coaxial or B82		
High Polarization Extinction Ratio (PER) Version Laser Module is also available, please contact us.			

Coaxial Package View: (Part Number: RWLP-505-020m-PM)

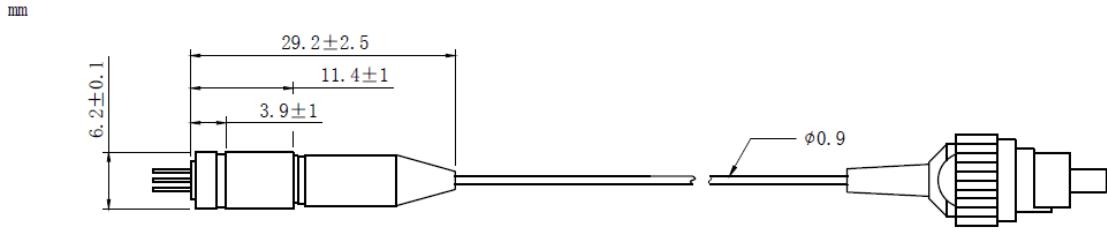

B82 Package View: (Part Number: RWLP-505-020m-PM-B)

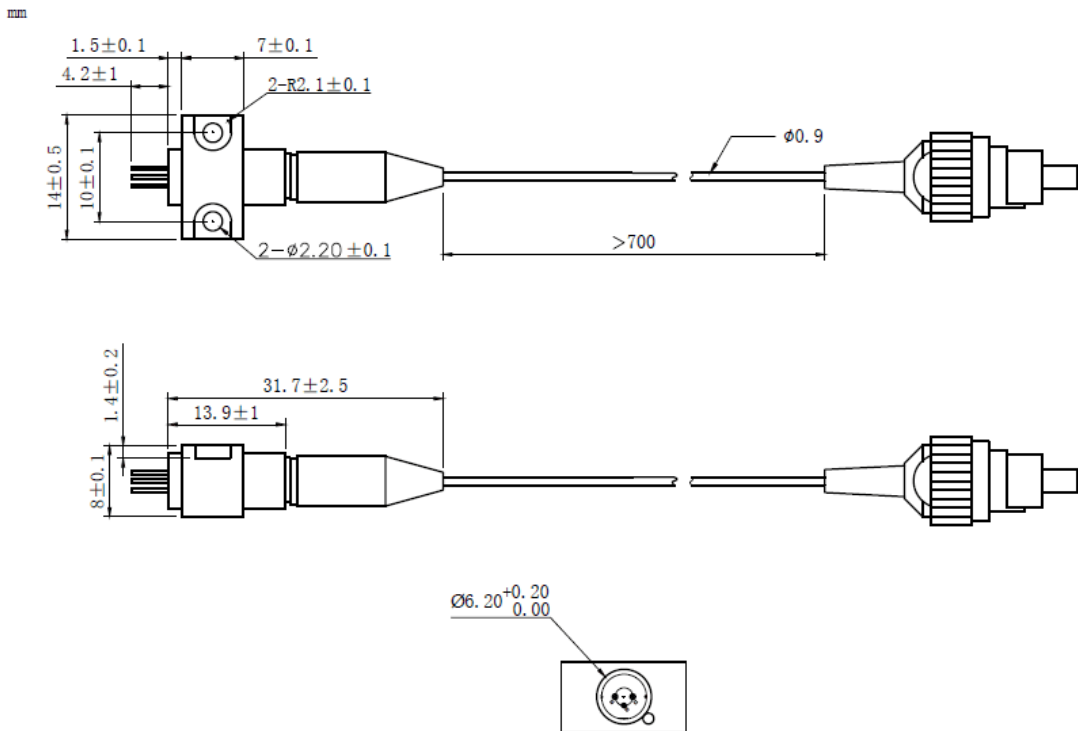

PIN Bottom View:

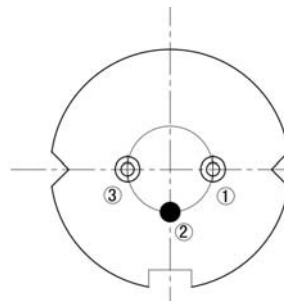

1	LD(+)
2	GND
3	LD(-)

Electrically shorten LD module and store in non-extreme conditions.
Suggest using the constant current power supply.

