

488nm~492nm 30mW Single Mode Coaxial Package Fiber Coupled Laser Diode Module
485nm~488nm~490nm SM Pigtailed LD with 3um Single Mode Fiber (SM Fiber) | Blue LDM
RWLP-488-030m-4

488nm Pigtailed Diode Laser		30mW/SMF	
PARAMETER	SYMBOL	VALUE	UNIT
Reverse Voltage	V_r	2.0	V
Operating Temperature	T_{op}	-10~+60	°C
Storage Temperature	T_{stg}	-40~+85	°C
Lead soldering temperature (10 sec.)	T_{is}	260	°C
Features: <ul style="list-style-type: none"> • 488nm Diode Laser • 3um SM Fiber • Coaxial or B82 Package • High Stability 			
Applications: <ul style="list-style-type: none"> • Medical Laser Treatment • Biotechnology • Others 			
Specifications	RWLP-488-030m-4		
	Min	Type	Max
Center Wavelength@25°C	480nm	488nm	495nm
Spectral Width (FWHM)	----	2.0nm	----
Output Power	----	30mW	----
Fiber Type	Single Mode Fiber		
Fiber Core	3um		
Recommend Operating Temperature	25°C		
Fiber Length	----	80cm	100cm
Threshold Current	----	35mA	70mA
Operating Current	----	150mA	170mA
Operating Voltage	----	6.5V	8.0V
Package Style	Coaxial or B82		
Fiber Connector	FC/SC/SMA905		
Photodiode	Without		

Coaxial Package View: (Part Number: RWLP-488-030m-4)

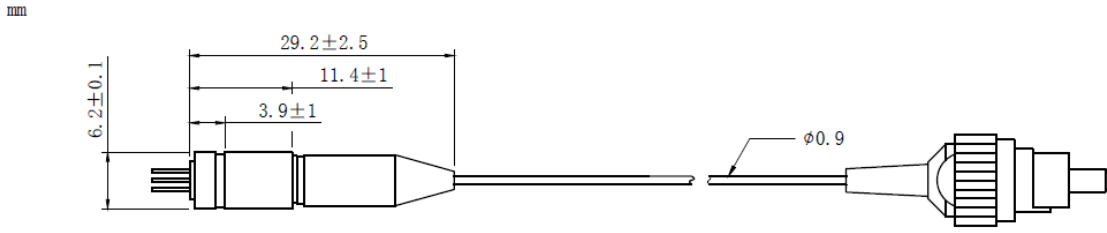

B82 Package View: (Part Number: RWLP-488-030m-4-B)

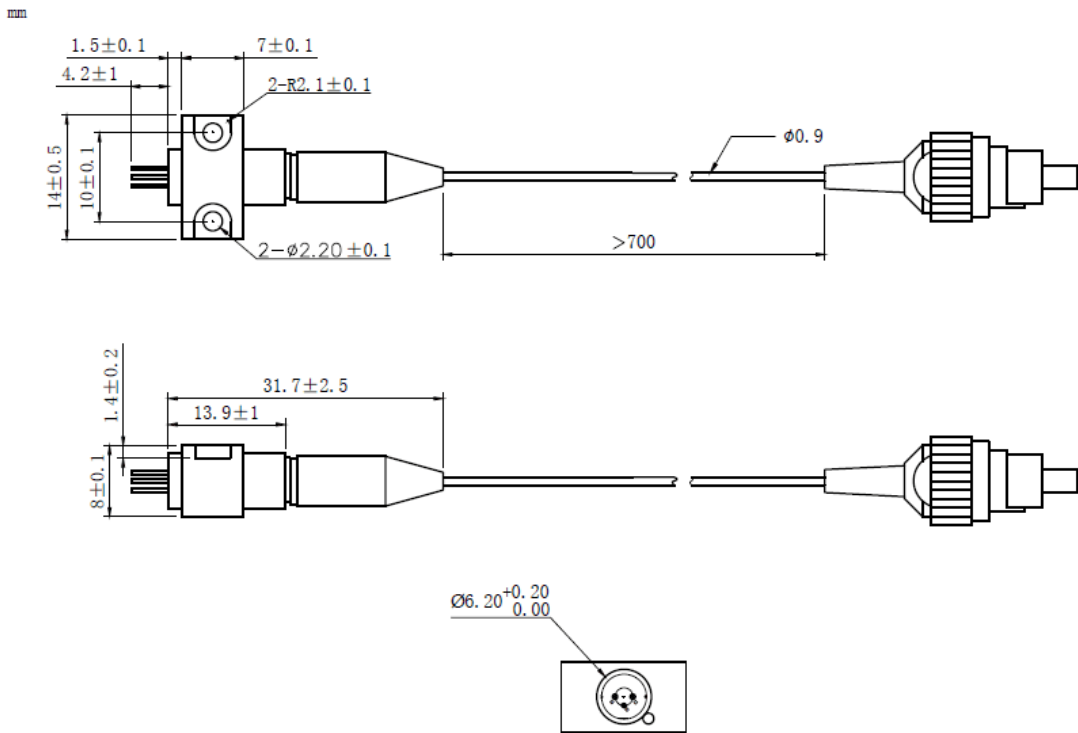

PIN Bottom View:

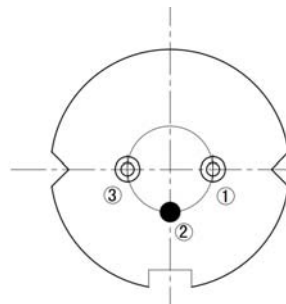

1	LD(+)
2	GND
3	LD(-)

Electrically shorten LD module and store in non-extreme conditions.
Suggest using the constant current power supply.

