

**473nm~480nm 10mW Single Mode Coaxial Package Fiber Coupled Laser Diode Module**  
**473nm SM Pigtailed LD with 3um Single Mode Fiber (SM Fiber)**  
**RWLP-473-010m-4**

473nm Pigtailed Diode Laser		10mW/SMF	
PARAMETER	SYMBOL	VALUE	UNIT
Reverse Voltage	$V_r$	2.0	V
Operating Temperature	$T_{op}$	-10~+60	°C
Storage Temperature	$T_{stg}$	-40~+85	°C
Lead soldering temperature (10 sec.)	$T_{is}$	260	°C
<b>Features:</b> <ul style="list-style-type: none"> <li>● 473nm Diode Laser</li> <li>● 3um SM Fiber</li> <li>● Coaxial or B82 Package</li> <li>● High Stability</li> </ul>			
<b>Applications:</b> <ul style="list-style-type: none"> <li>● Medical Laser Treatment</li> <li>● Biotechnology</li> <li>● Others</li> </ul>			
<b>Specifications</b>	<b>RWLP-473-010m-4</b>		
	Min	Type	Max
Center Wavelength@25°C	473nm±10nm		
Spectral Width (FWHM)	----	2.0nm	----
Output Power	----	10mW	----
Fiber Type	Single Mode Fiber		
Fiber Core	3um		
Recommend Operating Temperature	25°C		
Fiber Length	----	80cm	100cm
Threshold Current	----	25mA	60mA
Operating Current	----	110mA	130mA
Operating Voltage	----	6.5V	7.5V
Package Style	Coaxial or B82		
Fiber Connector	FC/SC/SMA905		
Photodiode	Without		

**Coaxial Package View: (Part Number: RWLP-473-010m-4)**

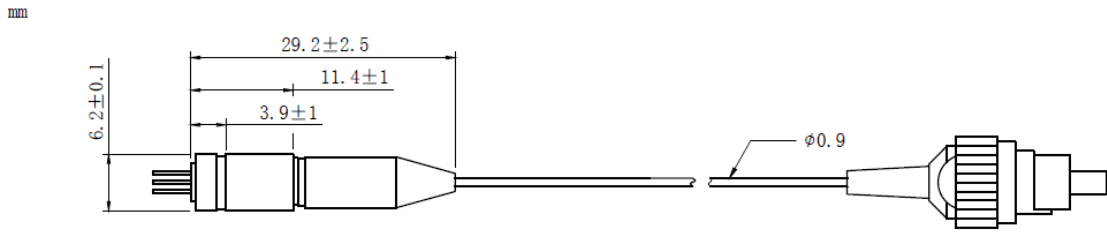

**B82 Package View: (Part Number: RWLP-473-010m-4-B)**

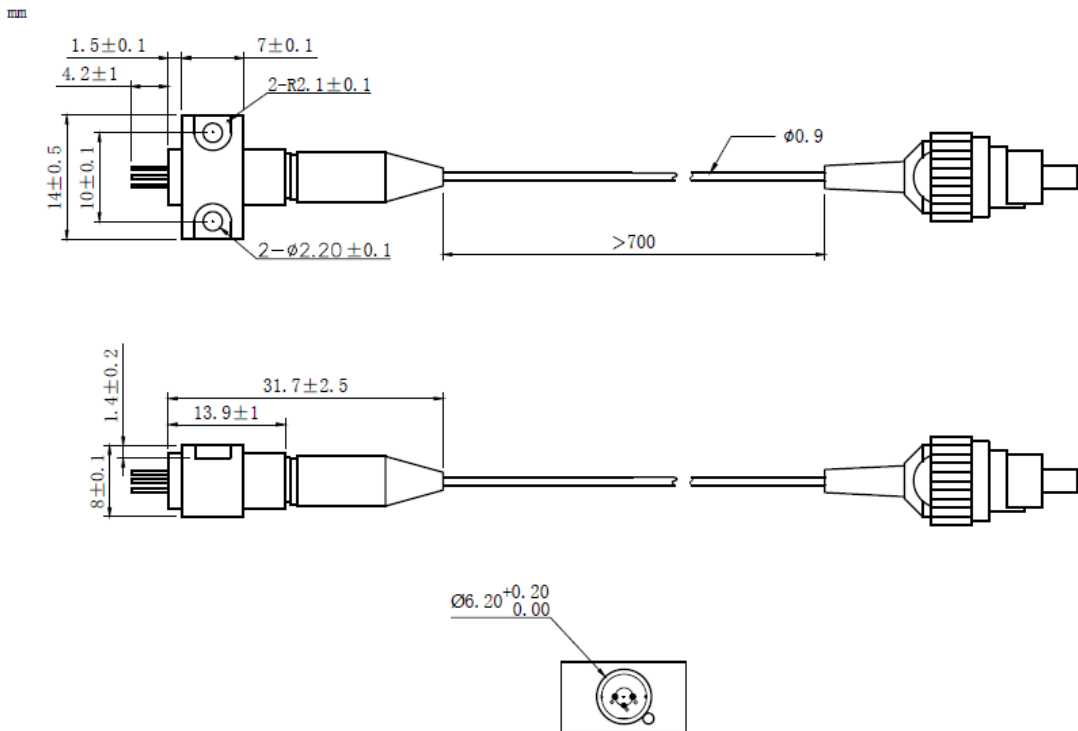

**PIN Bottom View:**

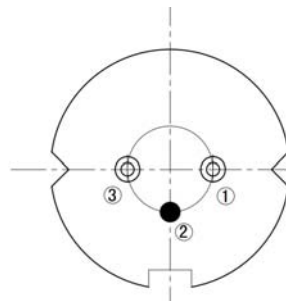

1	LD(+)
2	GND
3	LD(-)

Electrically shorten LD module and store in non-extreme conditions.  
Suggest using the constant current power supply.

