

1310nm 2mW FP Coaxial Pigtailed Laser Diode with Single Mode Fiber

1310nm SM Fiber Coupled LD with Single Mode Fiber (SM Fiber)

RWLP-1310-002m-9-FP

| PARAMETER | SYMBOL | VALUE | UNIT |
|---|-------------|--|-------------|
| LD Reverse Voltage | V_r | 2.0 | V |
| PD Reverse Voltage | $V_{r(PD)}$ | 15 | V |
| Operating Temperature | T_{op} | -40 ~ +85 | °C |
| Storage Temperature | T_{stg} | -40 ~ +100 | °C |
| Lead soldering temperature (10 sec.) | T_{is} | 260 | °C |
| Features: <ul style="list-style-type: none"> • 1310nm • FP Laser Diode • Built-in Photodiodes • 9um SM Fiber • Isolation Optional • Coaxial/Receptacle package | |  | |
| Applications: <ul style="list-style-type: none"> • Test Equipments • Optical Transmitter of Analog Signal • Optical Transmitter of Data Signal | | | |
| Specifications | | RWLP-1310-002m-9-FP | |
| | | Min | Type |
| Center Wavelength@25°C | | ±3nm | 1310nm |
| Laser Type | | FP | |
| Output Power | | ---- | 2mW |
| Fiber Core | | 9um SM Fiber | |
| Threshold Current (Typ.) I_{th} | | ---- | 5mA |
| Operating Current | | ---- | 30mA |
| Operating Voltage | | ---- | 1.3V |
| Spectral Width(FWHM) | | ---- | 2nm |
| SMSR | | ---- | 35dB |
| Monitor Current | | 0.1mA | ---- |
| PD Capacitance | | ---- | 10pF |
| PD Dark Current | | ---- | 0.1uA |
| Package Style | | Coaxial (Receptacle Optional) | |
| Recommended Operation Temperature | | 25°C | |

Coaxial Package View

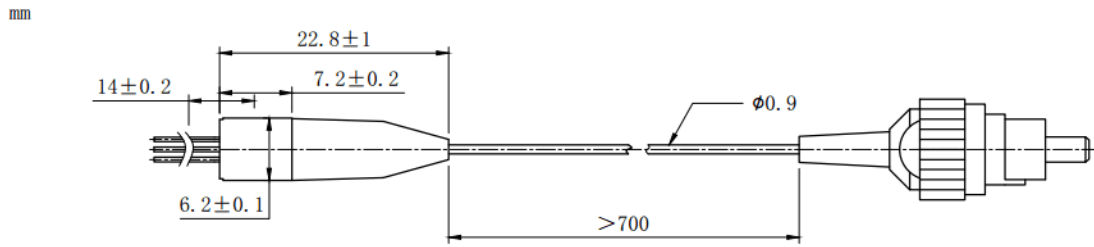

Pin Bottom View (A-Type)

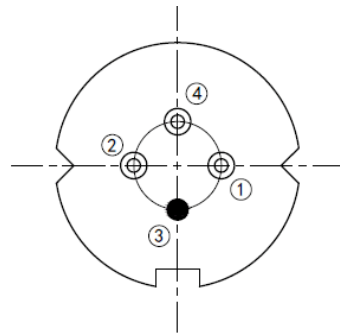

| | |
|-------|--------------|
| PIN 1 | PD (+) |
| PIN 2 | LD (-) |
| PIN 3 | LD (+), CASE |
| PIN 4 | PD (-) |

Electrically shorten LD module and store in non-extreme conditions.

Suggest using the constant current power supply.

